

## PICO<sup>o</sup> 7 Application Guide - Open Wound

Clean and prepare incision according to local protocol. Ensure periwound skin dry prior to dressing application. Can utilize a skin protectant, such as NO-STING SKIN-PREP<sup>o</sup>.

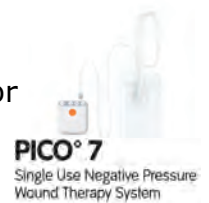

### Dress



1. Apply wound filler as needed. Peel off the first release handle and place the dressing centrally over the wound. The soft port should be above or to side of the wound, placed on intact skin.
2. Remove the other remaining handle(s) and smooth the dressing around the incision and borders. Reposition if required to ensure pad is not creased.

### Press

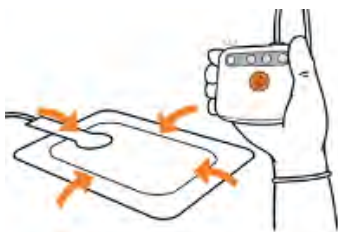

1. Insert the batteries into the device.
2. Join the device to the dressing by twisting together the tubing connectors.
3. Press the orange button to start the application of negative pressure.
4. Smooth dressing border & edges while gaining seal. Dressing will appear firm and compressed and green OK indicator will flash to confirm seal.

### Go

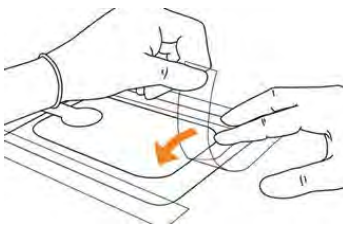

1. Apply the fixation strips to each of the four sides of the dressing.
2. The device has a 7 day life and the dressing may be left in place for up to 7 days depending on the level of exudate.
3. If a wound filler was used, dressing change will be dependent on wound filler recommended frequency of change.



Dressing full indicator will illuminate when dressing is saturated or filter is blocked, indicating a dressing change required.



Dressing properly positioned and is acceptable to be left in place

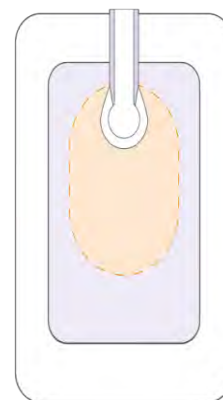

Dressing requires change

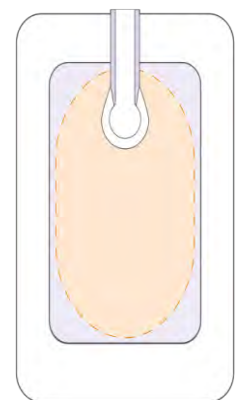

Dressing requires change

# PICO<sup>®</sup> 7 Tips for application on an open wound

PICO is indicated for use on closed incisions & wounds with anticipated small to moderate amounts of exudate; 50ml/ day or 300 ml/week

## Dressing selection:

When using PICO for moderately draining wounds the size of the wound should generally be **no more than 25% of the dressing pad area**

Ensure soft port is on intact skin and not extending over the wound. Soft port should be above or to the side of the wound

## Periwound preparation:

Remove any excess hair to ensure close approximation of the dressing to the skin and wound

Periwound skin should be dried well to promote a good seal.

Skin protectant (NO-STING SKIN-PREP<sup>®</sup>) can add protection to periwound skin and help with adherence to skin

## Use with a wound filler

Wounds greater than 0.5cm in depth are likely to require a foam or gauze NPWT filler to ensure adequate treatment of all the wound surfaces. ACTICOAT<sup>®</sup> Flex can be used when an antimicrobial is required.

Soft port to be applied on intact skin and not extending over the wound.



Utilize the RENASYS<sup>®</sup> Adhesive Gel patch for areas with contours & harder to seal areas. Assists in the creation of a long-lasting seal around wound margins; especially in challenging anatomical areas and/or in areas with moist skin.

When dressing application is complete, use a hand to smooth over the dressing and border to gently create contact with the dressing and patient's skin. Ensure seal is confirmed before applying fixation strips.

## Choosing a wound filler

When used with a filler, the PICO dressing should be changed according to filler recommendations.



Gauze



Foam

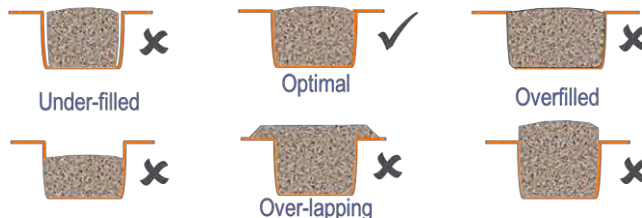

Use PICO 7 system with ACTICOAT<sup>®</sup> Flex 3 and Flex 7

